

# TRANSFORMERS

DARK OF THE MOON™



**WARNING:**

CHOKING HAZARD-Small parts.  
Not for children under 3 years.

**AGES 5+**

29684/28707 ASST.

DECEPTICON®

EASY

DECEPTICON HATCHET™ LEVEL: 1 2 3

NOTE: Some parts are made to detach if excessive force is applied, and are designed to be reattached if separation occurs. Adult supervision may be necessary for younger children.

## CHANGING TO VEHICLE

1. The robot is shown from a three-quarter view. The purple wings are being moved from the robot's back towards its chest.

2. The purple wings are now positioned over the robot's chest.

3. The purple wings are being moved further towards the robot's head.

4. The purple wings are now positioned over the robot's head.

5. The purple wings are being moved further towards the robot's front.

6. The purple wings are now positioned over the robot's front.

7. The purple wings are being moved further towards the robot's front.

8. The purple wings are now positioned over the robot's front.

9. The purple wings are being moved further towards the robot's front.

10. The purple wings are now positioned over the robot's front.

11. The purple wings are being moved further towards the robot's front.

12. The purple wings are now positioned over the robot's front.

13. The purple wings are being moved further towards the robot's front.

14. The purple wings are now positioned over the robot's front.

15. The purple wings are being moved further towards the robot's front.

16. The purple wings are now positioned over the robot's front.

**VEHICLE MODE**

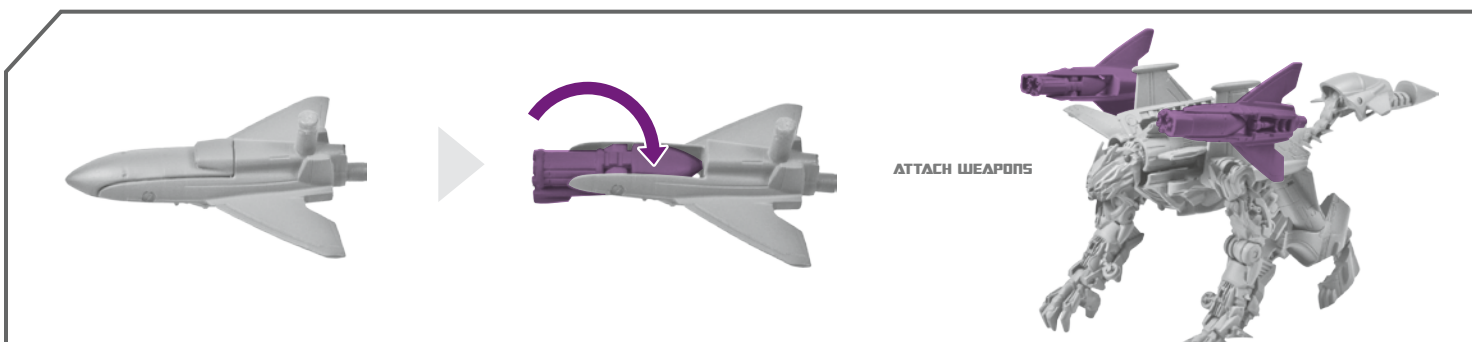
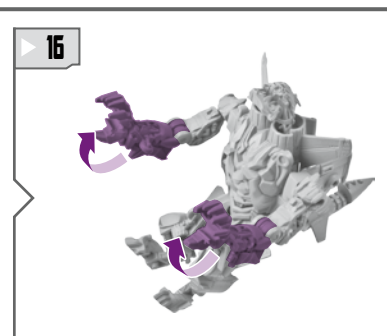
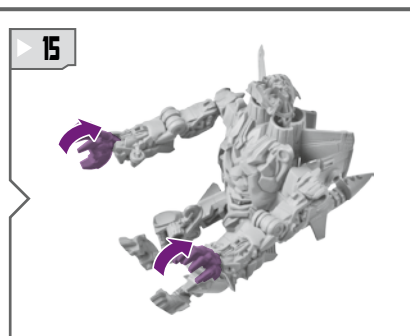
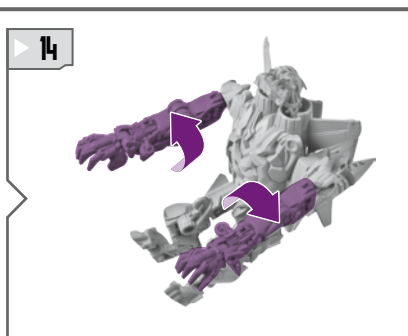
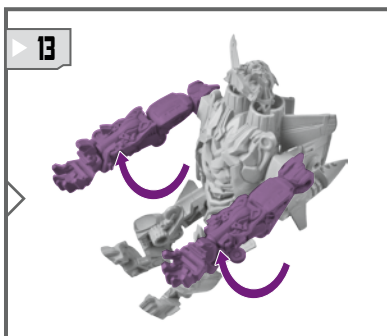
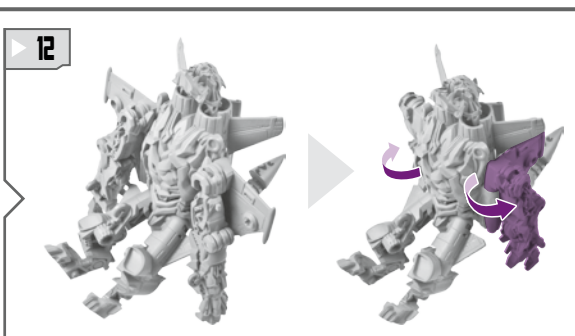
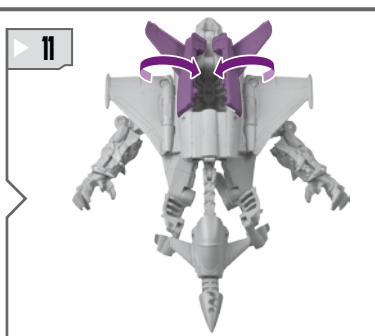
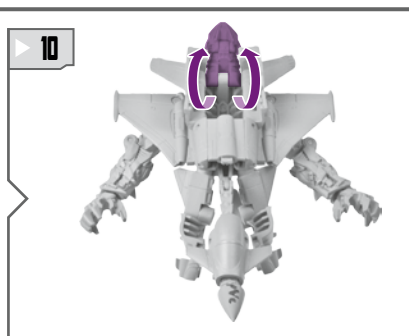
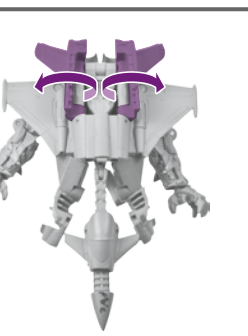
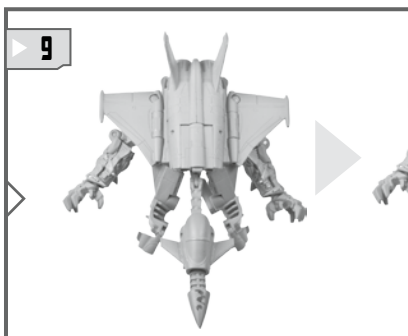
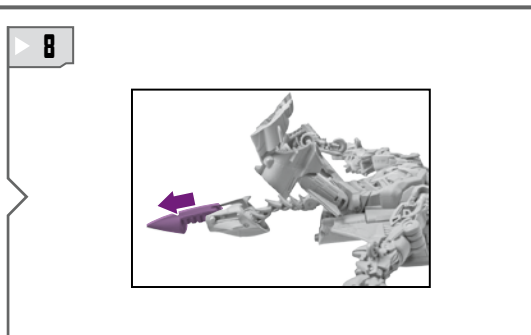
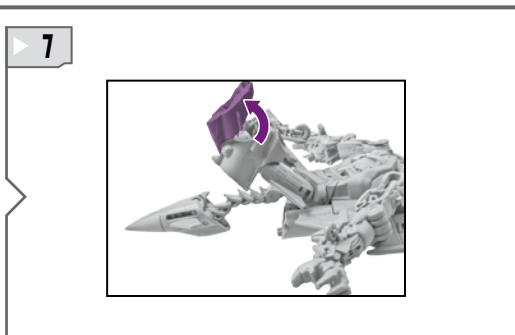
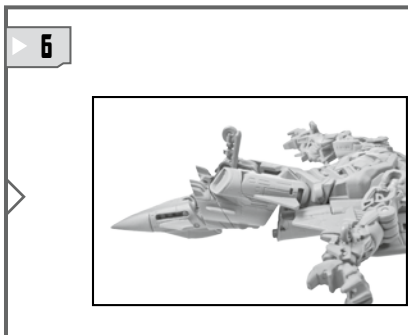
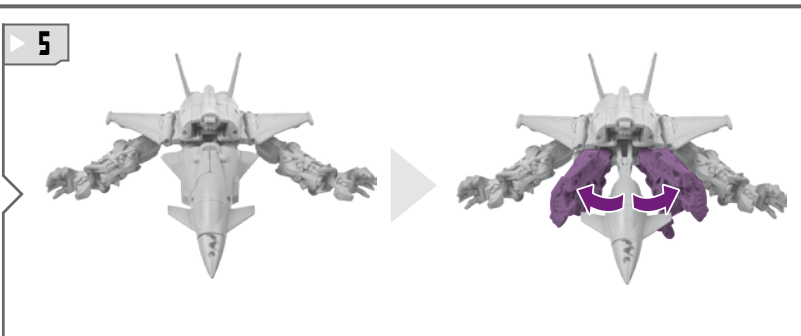
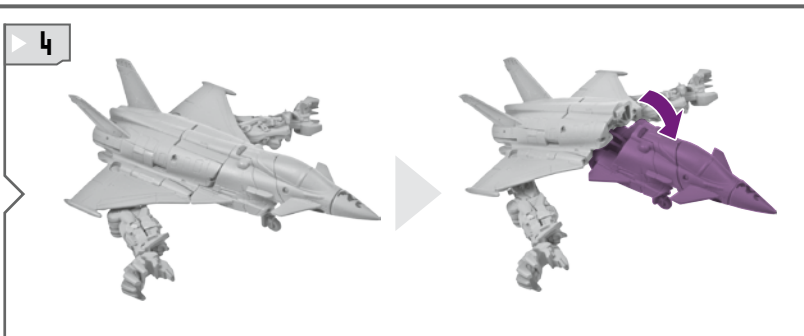
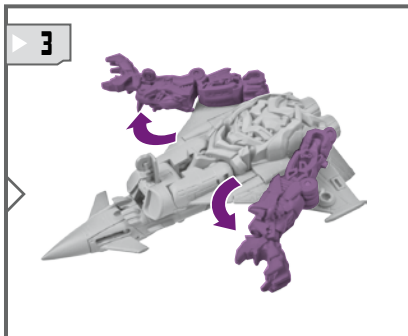
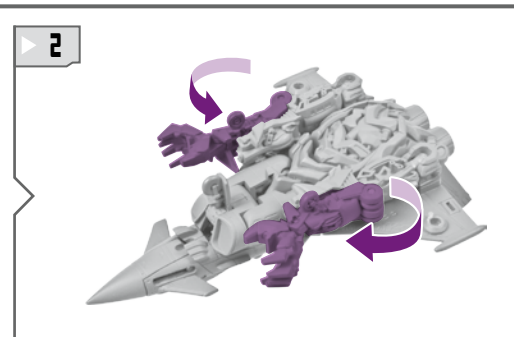
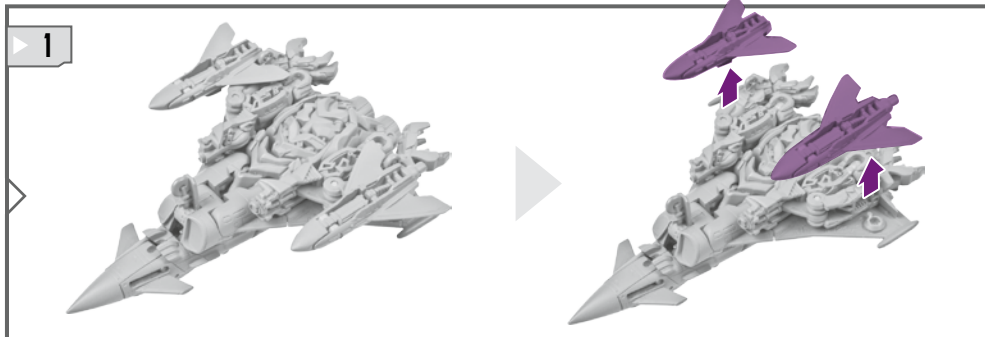

Retain instructions for future reference.



Product and colors may vary. Some poses may require hand support.  
 © 2011 Paramount Pictures Corporation.  
 Manufactured under license from TOMY Company, Ltd.  
 © 2011 Hasbro. All Rights Reserved. TM & © denote U.S. Trademarks.



P/N 716302000

TRANSFORMERS.COM/INSTRUCTIONS